

LANE RESTRICTIONS

Eastbound Century Boulevard at Avion Drive

Saturday, June 22 at 12AM through Monday, June 24 at 5AM

ACTIVITY

To facilitate roadway paving for the APM project, eastbound lanes on Century Boulevard at Avion Drive, including a portion of Avion Drive, will be restricted Saturday, June 22 at 12AM through Monday, June 24 at 5AM.

On eastbound Century Boulevard, the two left turn lanes to northbound Avion Drive or U-turn toward LAX will be closed; traffic will be detoured to Airport Boulevard. Eastbound through traffic will be maintained at all times.

Southbound Avion Drive through traffic at the intersection or left turn to eastbound Century Boulevard will be closed; traffic must turn right to westbound Century Boulevard.

Westbound Century Boulevard left turn to southbound Avion Drive will be closed; all other westbound traffic is maintained and not impacted by this work.

When southbound Avion Drive is inaccessible, Cargo and Lot F tenants will be directed to use Airport Boulevard to reach facilities (see additional maps on Page 2).

Pedestrians will be detoured to Airport Boulevard. Flaggers and signage will be in place to assist with wayfinding and maintenance of traffic. Please use caution when traveling near construction areas and plan ahead for potential delays.

Note: From 8PM on Saturday, June 22 through 5AM on Monday, June 24, the northbound Sepulveda Boulevard ramp to eastbound Century Boulevard will be closed; the portion of this ramp leading to the LAX Airport Entry flyover will remain open. Detours and signage will be in place.

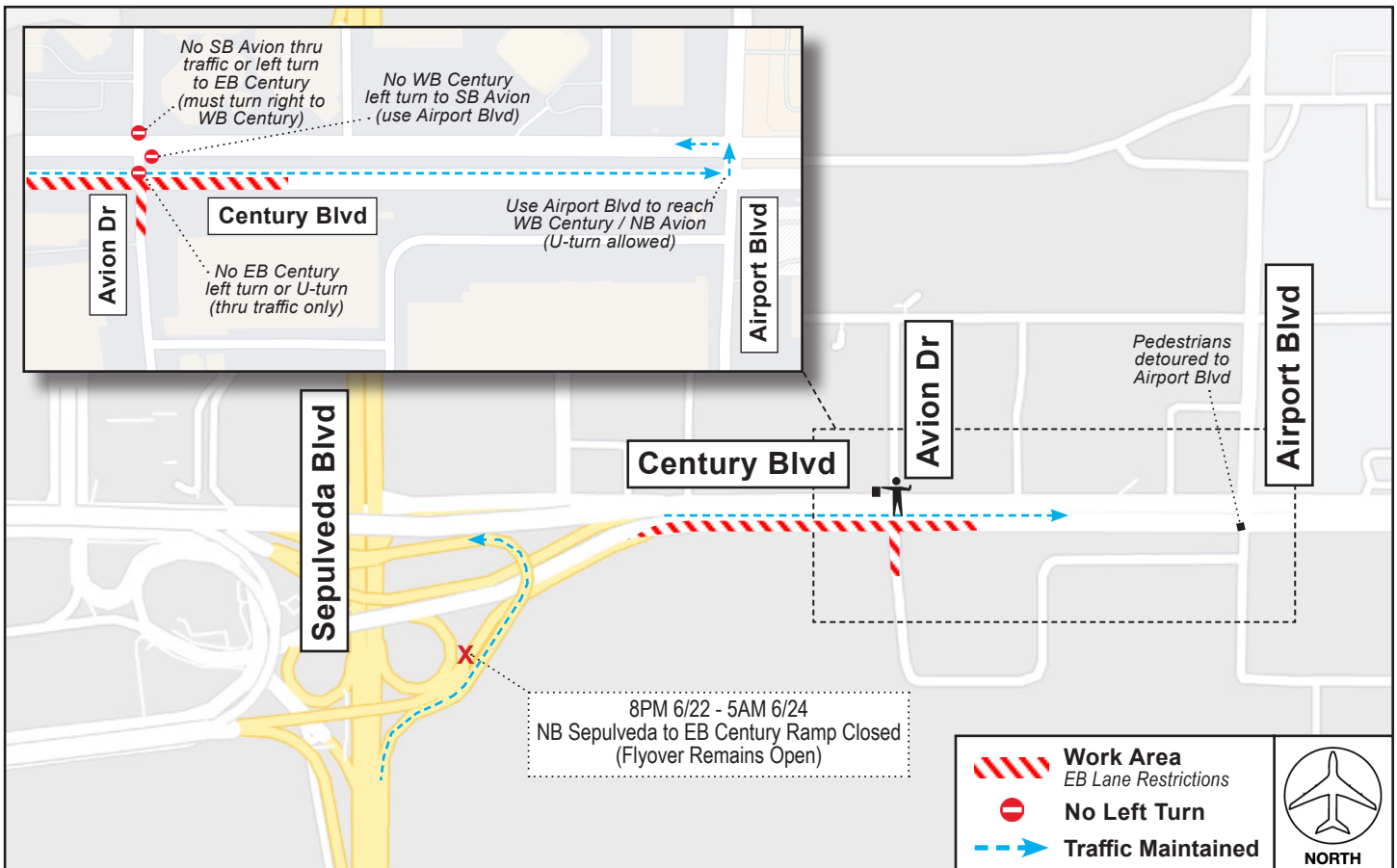

LANE RESTRICTIONS

Eastbound Century Boulevard at Avion Drive

Saturday, June 22 at 12AM through Monday, June 24 at 5AM

CARGO ACCESS

Cargo will use Airport Boulevard to reach facilities while Avion Drive is inaccessible from Century Boulevard, and the same detour route to exit. Flaggers will be deployed to direct incoming and outgoing traffic and maintain access at all times.

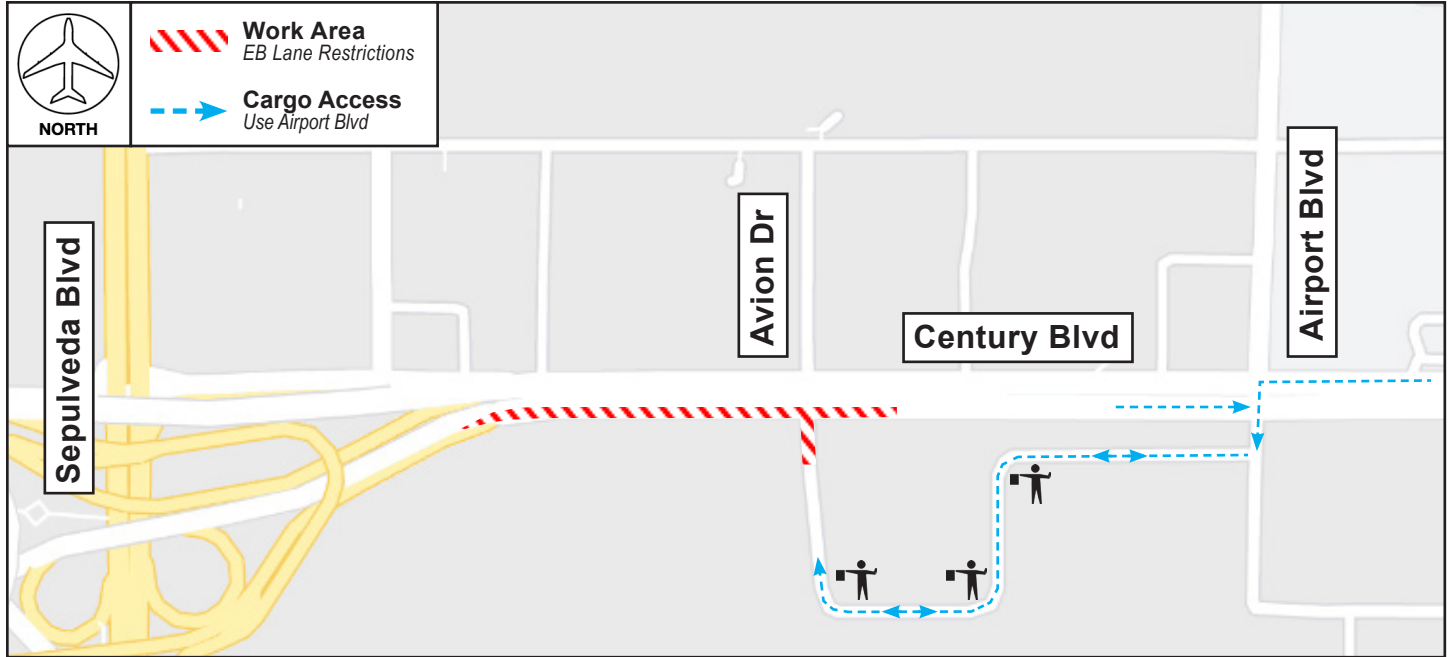

LOT F ACCESS

Lot F will be accessible via Airport Boulevard. Flaggers will be deployed to direct traffic and maintain access at all times. Shuttle service will be provided from Lot F to cross Century Boulevard, illustrated below.

