

LANE RESTRICTIONS

Arrivals Level - South Knuckle

Thursday, July 30 through Thursday, August 6, 2020

Nightly, Monday through Friday: 1AM to 6AM



ACTIVITY

To facilitate potholing work, the Automated People Mover project will restrict three Arrivals Level Outer Lanes at the South Knuckle beginning Thursday, July 30 through Thursday, August 6, nightly from 1AM to 6AM (Monday through Friday nights only).

IMPACTS

RESTRICTED:

- Arrivals Level Outer Lanes 1, 2 and 3 between Terminal B and Terminal 4
- South Knuckle Rental Car Shuttle Stop between Terminal B and Terminal 4
 - Signage will be in place directing guests to the next available shuttle stop

MAINTAINED:

- CTA through traffic will be maintained at all times via the Pick-Up Lane at the South Knuckle
- Parking Structure 4 access will be maintained at all times
- Inner Lane shuttle operations (LAX-it, FlyAway & LAX Shuttles) will be maintained at all times

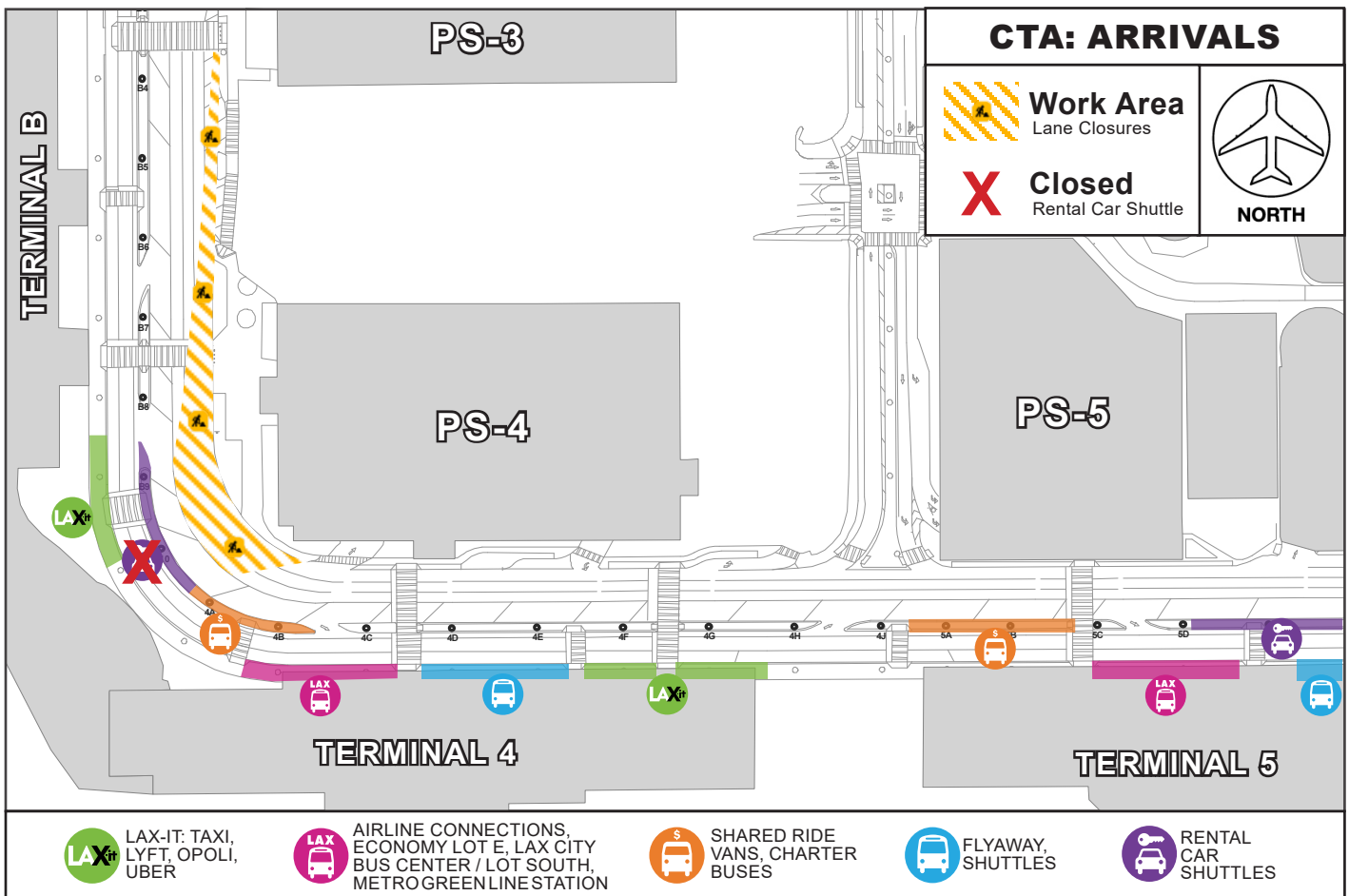

LAX Construction Hotline: 310-649-5292 | @FlyLAXAirport | LAInternationalAirport
LAXConstructionHotline@LAWA.org